

DESCRIPTIVE FEATURES

INSULATION THICKNESS 70 mm

AISI 304 STAINLESS STEEL

ROUNDED EDGES

EVAPORATOR WITH CATAPHORESIS TREATMENT

DISTANCE BETWEEN RACK RAILS 65 mm

ACCESSORIES

ACC 509
Heated core probe

ACC 110
Ozone sterilizer

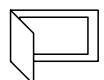
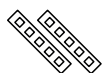
ACC 141
Kit 4 Castors

ACC 135
Door Opening Left

ACC 148
Luce Led

ACC 800/4
Surcharge for EN 60X40
Trays Holder

 Special voltages on
request

ROOM CONDITIONS

+32°C

60% UR

SPECIFICATIONS IN COMPLIANCE WITH prEN 17032

Blast Chilling (+65°C / +10°C)		Deep Freezing (+65°C / -18°C)	
Max. Capacity	Time	Max. Capacity	Time
50 kg	120 min	30 kg	260 min

CONSUMPTION (prEN 17032)

Blast Chilling	Deep Freezing
+90°C / +3°C	+90°C / -18°C
0,11 kWh/kg	0,33 kWh/kg

REFRIGERANT GAS

Type	GWP	Charge
R452A	2141	2,0 kg

TECHNICAL DATA

<p>Model</p>	MXE14.50	<p>Standard tension</p>	400 V / 3 Ph+N 50 Hz	<p>Refrigeration Evap. -30°C Cond. +45°C</p>	2.700 W Evap. -30°C Cond. +45°C
<p>Version</p>	ARIA	<p>Power consumption</p>	3,0 kW / 11,0 A	<p>Dimensions</p>	798 x 808 x 1860/1900 mm
<p>Capacity</p>	14 GN1/1 14 EN 60X40	<p>HP</p>	3,5 HP	<p>Net Weight</p>	205 kg
<p>Blast Chilling</p>	50 kg +90°C → +3°C 90 min	<p>Noise</p>	<70 dB	<p>All set up</p>	GN 1/1 EN 60X40
<p>Deep Freezing</p>	30 kg +90°C → -18°C 240 min	<p>Refrigeration power -10°C</p>	7.920 W Evap. -10°C Cond. +45°C		

SET-UP

ACTIVA GN 1/1 - EN 60X40

●	Blast chilling positive (+3°C)
●	Freezing (-18°C)
●	Positive holding (+3°C)
●	Negative holding (-18°C)

DIMENSIONS

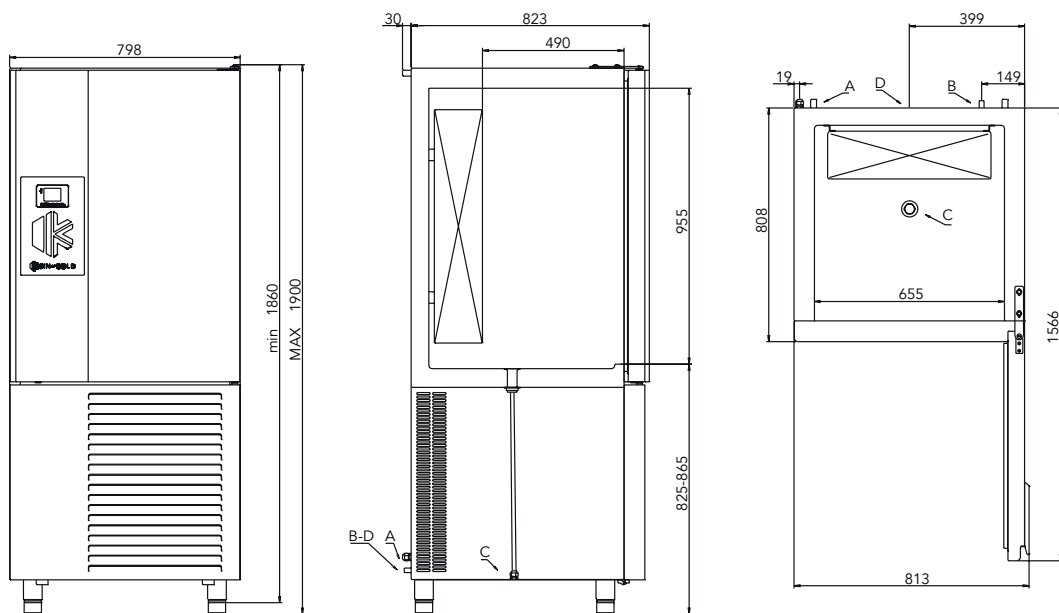

CONNECTIONS

- A** Electrical connection
- B** Water connection (on request)
- C** Drain
- D** Refrigeration Connection (on request)